



DESCRIZIONE

| | |
|---------------------------|--|
| Tipologia | Madia |
| Struttura | Pannello di particelle di legno impiallacciato |
| Top | Pannello di particelle di legno impiallacciato o marmo |
| Piedi | Alluminio verniciato |
| Ripiani | Vetro |
| Struttura cassetti | Pannello di particelle di legno nobilitato |

DIMENSIONI

Due ante battenti, un cassetto e un vano a giorno

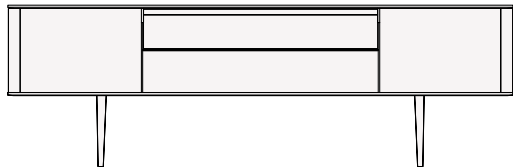

2128
83 3/4"

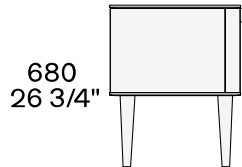

680
26 3/4"

548
21 1/2"



Due ante battenti e due cassetti

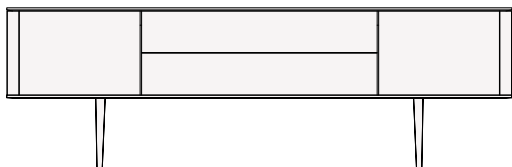

2128
83 3/4"

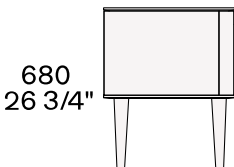

680
26 3/4"

548
21 1/2"



Due ante battenti e tre cassetti

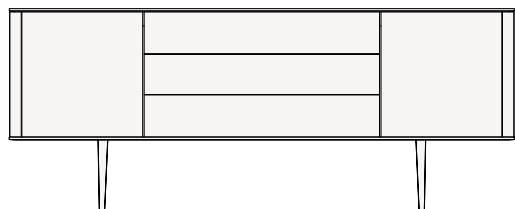

2128
83 3/4"

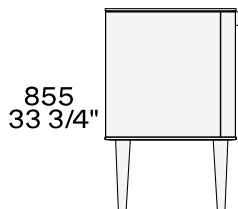

855
33 3/4"

548
21 1/2"

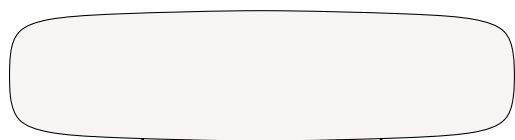

Due ante battenti

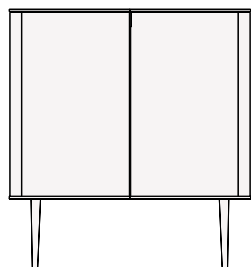

1018
40"

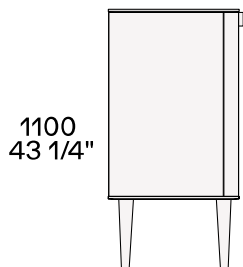

1100
43 1/4"

548
21 1/2"

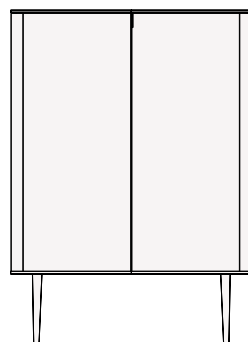

1018
40"

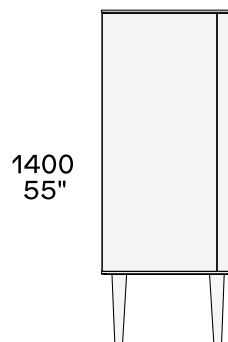

1400
55"

548
21 1/2"

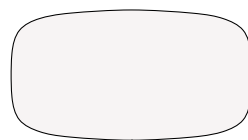
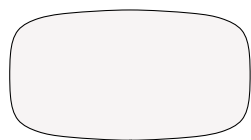

Due ante battenti, un cassetto e un vano a giorno

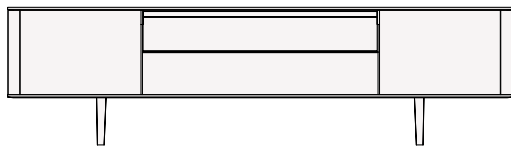

2128
83 3/4"

580
22 3/4"

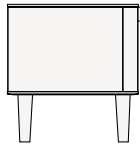

548
21 1/2"

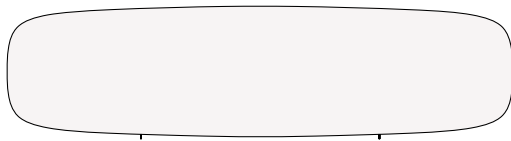

Due ante battenti e due cassetti

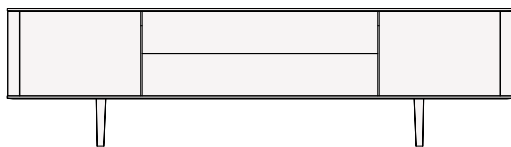

2128
83 3/4"

580
22 3/4"

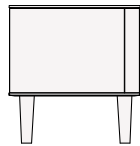

548
21 1/2"

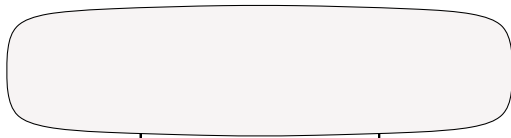

Due ante battenti e tre cassetti

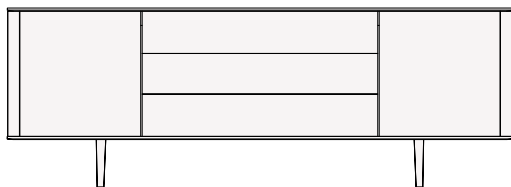

2128
83 3/4"

755
29 3/4"

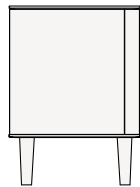

548
21 1/2"

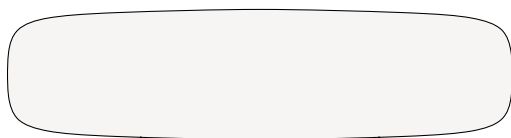

Due ante battenti

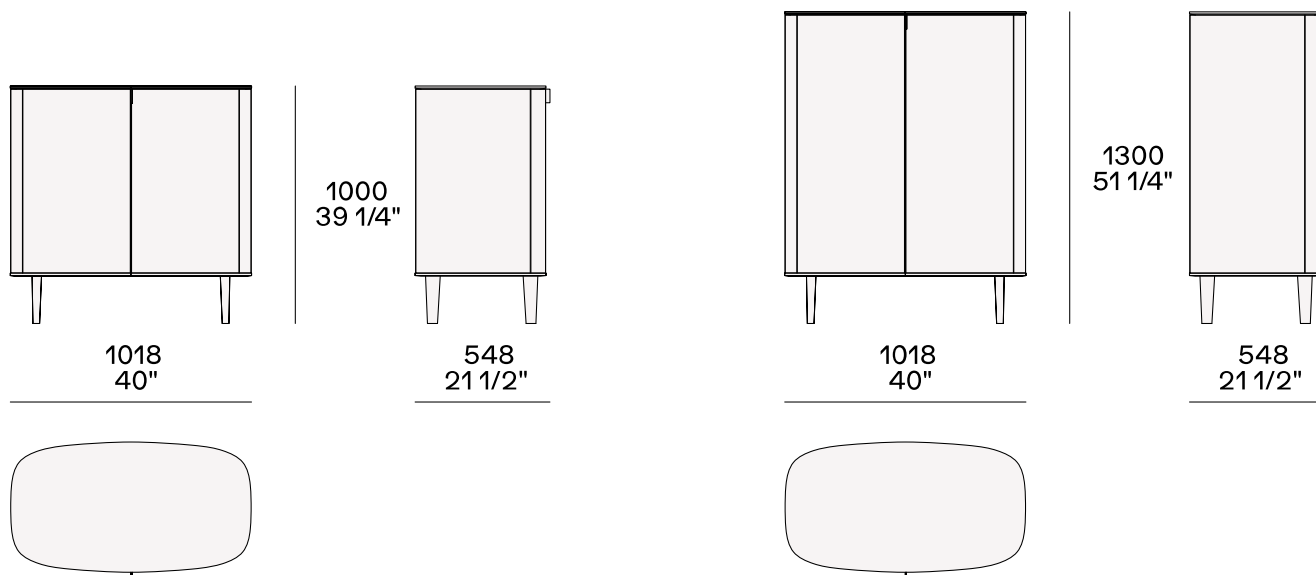

FINITURE STRUTTURA

Essenza

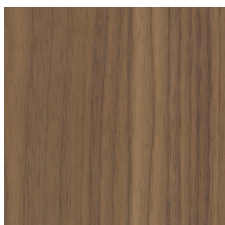

Essenza

FINITURE BASAMENTO

Parti metalliche



Parti metalliche

FINITURE TOP

Essenza



Essenza

Marmo

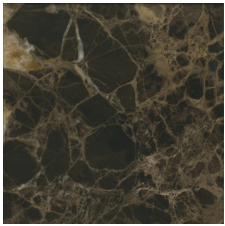

Marmo levigato



Marmo lucido